

16" PANEL 8'- 24' STANDARD SIZE CUSTOM LENGTHS AVAILABLE



Moldings

ALL MOLDINGS COME IN 10' LENGTHS

BASE TRIM

Use: Bottom Trim

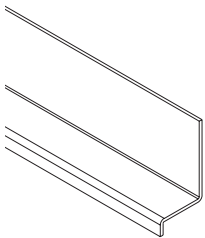

OUTSIDE CORNER

Use: Outside Corner

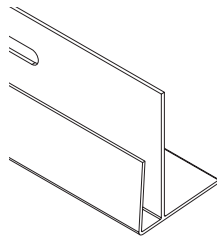

L-ANGLE

Use: Corner Cap

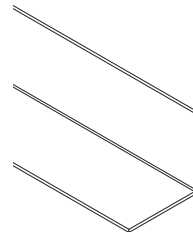

J-CHANNEL

Use: Top/bottom End Cap

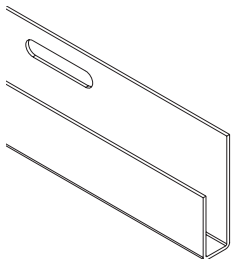

H-CHANNEL (2 PCS)

Use: Divider or Transition

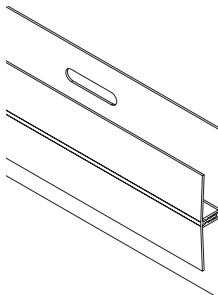

INSIDE COVE

Use: Inside Corner

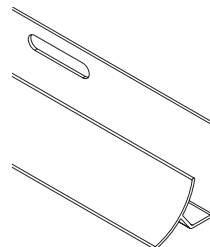

PLEASE READ ALL INSTRUCTIONS BEFORE BEGINNING INSTALLATION

About Installation Guide

- These guidelines aim to prevent common installation errors. Responsibility for installation decisions rests with the installer, not the manufacturer or distributor.
- Certain details of installation, assumed to be well-known in the construction industry, are not covered in these instructions.
- These guidelines are meant to serve as recommendations only, and should not be treated as a comprehensive, fail-safe installation manual.
- Choosing a qualified installer is entirely the responsibility of the project owner and architect.
- Creative Panel Solutions, LLC disclaims any liability for job failures due to inappropriate site conditions or issues arising from material expansion and contraction.
- Inspection Guidelines: Immediately upon delivery, thoroughly inspect all containers, packages, and protective materials for any signs of damage or missing items.
- Examine any suspect packages or pallets for damage.
- Immediately report any damages or missing items to the shipper. Delays in reporting may result in the installer assuming all associated risks.
- Report any defective materials to CPS within 24 hours of receiving the panels. Delayed reporting will also be the installer's responsibility.
- Uses & Applications: TekKor® panels are low-maintenance and can be quickly installed in multiple orientations directly onto studs or substrates. They are versatile and suitable for various settings including clean rooms and agricultural buildings.

Recommended Tools

- Ladders/Scaffolding
- Rubber Mallet
- Rotary Hammer Drill
- Drill C/W Hole Saws
- Caulking Gun
- Circular Saw With Fine Tooth Blade
- Tape Measure
- Box Cutter & Tin Snips
- Battery Powered Drill
- Square & Straight Edge
- Chalk Line

General Recommendations

Temperature Range

TekKor® Wall & Ceiling System is designed to be installed between 10-20°C (50-68°F).

Panel Cutting

For a reliable method to prevent cracking or chipping in the TekKor® Wall & Ceiling System, consider using a saw blade specifically designed for cutting vinyl products. Another option is to install standard saw blades in reverse. Avoid using coarse-toothed blades for optimal results. Additionally, you can opt for concrete/masonry blades if needed. Apply steady pressure when cutting to ensure smooth results. In cold temperatures, proceed slowly to avoid damage. Conduct a test cut to assess your cutting tool's performance before starting your project. Always wear safety goggles and a face mask when using a power saw. Remember, any leftover materials can be recycled.

Panel Cutouts

For creating openings for electrical boxes, lights, taps, etc., utilize a jigsaw, oscillating saw, or hole saw. When making square cut-outs, measure and mark the perimeter, then carefully cut along the lines starting from a drilled hole at one corner, ensuring the area behind is obstruction-free.

Long Panel Runs

When installing TekKor® Wall & Ceiling System in applications that require a long, continuous run of panels, it is recommended to install an expansion joint to accommodate panel expansion and contraction.

Ripping Panels

Occasionally necessary in TekKor® Wall & Ceiling System installations, a rip-cut, a woodworking technique, ensures straight-line cuts parallel to the board/panel length, crucial for maintaining even panel spacing; plan the layout beforehand and ensure ripped panels are at least 8" wide, cutting both the first and last panels if needed. If you are cutting the first panel, cut off the tongue side

- If you are cutting the last panel, cut off the groove (screw flange) side When measuring the coverage needed, measure only the panel profile (exposed face), not the nailing flange.
- When installing the last panel of the wall, a putty knife can be helpful in bending the J Channel back to create enough space to get the panel into the trim.

Fastening

The TekKor® Wall & Ceiling System, designed for screw installation, necessitates #8/#10 gauge screws with a minimum 3/8" head diameter, preferably corrosion-resistant varieties like truss head, pancake head, round or washer head, cabinet, and other low profile screws. Recommended screws include #8 or #10 X 1-1/4" wood screws with round or washer heads, truss heads, pancake heads, cabinet heads, or other low-profile options, such as the #8 x 1-1/4" Round Washer Head Steel Particle Board Screw. For concrete, opt for 3/16" x 1-1/4" flathead screws like Tapcon. When working with metal studs, use self-tapping screws instead of wood screws. Adjust screw length according to the application: 1-3/4" to 2" for drywall, and 2-3/8" for furring strips or strapping. In highly corrosive or moist environments, stainless-steel screws are recommended to prevent damage to the panels and to uphold the warranty.

Fastening tips

- Fasten screws without over-tightening.
- Maintain a minimum 1/16" gap between the back of the screw head and the screw flange.
- •Always fasten at the center of screw flange slots to prevent panel buckling or distortion.
- •Install screws straight and level to accommodate movement.
- •Allow panels to slide freely after fastening to accommodate expansion and contraction.
- •Ensure screws penetrate a minimum of 1" into solid backing.
- •Installation Vertically, use one screw every 2' of TekKor® panel or trim.
- •Installation Horizontally, place one screw at each stud location, typically every 16" or 24".

Drywall Anchors

When solid backing isn't available, drywall anchors are recommended. Use screws whenever possible, following guidelines, but if solid backing is lacking, use one or two drywall anchors per panel, tapping them through the screw flange with a hammer and fastening until flush with the drywall anchor head.

Panel Spacing

To accommodate expansion and contraction, ensure a minimum clearance of 1/4" at the ends of all panels and trims, increasing to 1/2" for lengths exceeding 20 feet. For vertical panels resting flush on the bottom J Channel or Base Trim, leave a 1/2" clearance at the top, as expansion primarily occurs there.

High-Moisture Environments

In high-moisture environments like car washes, adhere to these guidelines when installing TekKor® Wall & Ceiling System:

- Orient panels vertically for optimal drainage.
- Apply a thin bead of silicone along the tongue of each panel, ensuring a snug fit into the groove of the previous panel, and remove any excess silicone.
- If employing J Channel at the wall base, follow the Trim application guidelines to drill drainage holes in the trim. (FIGURE A)

FIGURE A



Use of Silicone Sealant

For optimal sealing, it's advised to utilize silicone sealant for all corners, around fixtures, and for minor hole repairs. To ensure color matching, compare a sample of TekKor® with the color indicated on the silicone tube in-store, considering regional variations in colors and brands.

Cleaning

Day-to-Day Cleaning

To remove common dirt and maintain your TekKor® product's beautiful appearance, wash using a sponge or soft cloth and a mild cleaning solution. View the [Cleaning & Disinfecting Guidelines](#)

If the dirt is difficult to remove, wipe clean with a solution of:

- 1/3 cup laundry detergent (e.g., Tide®)
- 3.79 L (1 Gallon) of water Swiffer® Dusters™ are very helpful in removing dust from TekKor® Wall & Ceiling System. Mr. Clean® Magic Erasers™ can be used to remove marks on TekKor® Wall & Ceiling System.

Pressure Washing

When hand cleaning doesn't get the job done, pressure washers may be used with mild soap and a sponge or soft cloth, provided the guidelines below are followed:

- Power washing nozzle should be at least 4-6 ft away from the wall
- Use a small-to mid-size power washer with less than 3,000 psi
- Use a wide spray nozzle angle (40° or greater is preferred) to distribute the water pressure across the wall

CFIA, USDA & FDA Approved Installations

TekKor® Wall & Ceiling System panels are fully compliant with the requirements set out by the CFIA, USDA and FDA for areas where food is prepared. In these applications, the following guidelines must be followed.

- The product is strictly for use on non-food contact surfaces
- All joints are to be sealed with an acceptable flexible caulking compound to provide a smooth, flush, and impervious joint. Silicone must meet FDA Reg. 21, CFR 177.2600 and are certified to NSF/ANSI Standard #51.

Planning & Preparation

To ensure optimal installation, TekKor® Wall & Ceiling System should acclimate in the installation location for at least 24 hours prior to installation, minimizing post-installation expansion or contraction.

Planning Your Installation

- Ensure surfaces are straight and install furring strips or strapping where needed, ensuring all vapor barriers are up to code before installing TekKor® Wall & Ceiling System.
- Install TekKor® Wall & Ceiling System perpendicular to ceiling joists or roof trusses, using 1"x4" or 2"x4" furring strips or strapping where necessary, or ensure joists are 16" on-center for parallel installation.
- If furring strips or strapping are necessary, install them perpendicular to framing members at 24" on-center.
- Place wood blocking around openings to adequately support trims.
- Provide adequate backing for suspended lights or other items, avoiding direct mounting onto TekKor®.
- Only start installation once the building is fully enclosed, heating/cooling systems are operational, and any residual construction moisture has been eliminated.

Vertical Installation

When installing TekKor® Wall & Ceiling System vertically on both walls and ceilings, begin with the ceiling installation for optimal results.

Ceiling Installation:

1. Cut the first panel to size for the initial row, ensuring it is parallel to the outer wall before fastening.
2. Leave a 1/8" gap between the panel's tongue side and the wall, fastening every 24" with recommended screws, and avoiding over-tightening.
3. Use the H Channel (2 Piece) to join panels if needed for longer ceilings.
4. Install J Channel along the top of the wall below the ceiling panels to provide support and ensure proper alignment.
5. Continue installing panels row by row, ensuring a snug fit and proper connection between panels.
6. Check alignment periodically by measuring the distance from the wall to panel edges.
7. Trim the final panel if necessary, leaving a 1/8" gap between the wall.
8. Insert the last panel and install J Channel along the top of the wall below to complete the installation

Drywall Grid Ceiling Installation

If TekKor® is being installed as part of a drop ceiling using drywall grid designed for screw-fastening applications, follow these guidelines:

- Install panels perpendicular to the drywall grid.
- Plan ahead for trim installation directly into the grid, preferably onto main beams or with added cross tees for support.
- Fasten panels into the grid from below to ensure waterproofing; dropping panels into the grid is not suitable for this application.
- Arrange the grid so panels are fastened at maximum 24" apart on-center.
- Consider using #12 x 3/4" pan head stainless steel screws for fastening.

Wall Installation:

1. Start by installing Base Trim or J Channel along the bottom of the wall, ensuring consistency with trimming guidelines provided in the document's Trim Applications section, and maintain the same corner-trimming approach for both top and bottom trim pieces.
2. Use J Channel or Inside Cove Trim for corners, beginning with the corner where the J Channel was cut 3/8" short, and offset the vertical trim piece by 3/8" to accommodate the final wall panel insertion. Then, proceed with installing perimeter trims around door or window openings.
3. Install the remaining J Channel at the top of the walls.
4. Cut the first panel to size, starting from the corner where the J Channel was cut 3/8" short, ensuring alignment with the outer wall before fastening. Maintain a 1/8" gap between the panel's tongue side and adjoining trim, and secure with recommended screws spaced at maximum 24" apart.
5. Allow a 1/4" clearance at both ends of panels for expansion and contraction, avoiding over-tightening screws.

6. Install subsequent wall panels, interlocking the tongue of each new panel with the groove of the previous one, ensuring a secure connection before fastening.
7. Regularly check panel alignment by measuring distances from the wall at both top and bottom edges, ensuring even installation.
8. Trim the final panel as needed, maintaining a 1/8" gap between the panel edge and the wall.
9. Install the next corner trim piece after the final wall panel, ensuring a tight fit against the corner and secure it to the wall.
10. Repeat steps 4 through 9 for the remaining panels on each wall.
11. When returning to the starting corner, insert the panel behind the trim with the 3/8" gap, ensuring adequate space for insertion and pressing firmly against the previously installed panel for a secure connection.

Horizontal Installation

If TekKor® Wall & Ceiling System is being installed horizontally on the walls of a project as well as the ceiling, it is recommended to start with the walls first before installing panels on the ceiling.

Wall Installation:

1. Start by installing Base Trim or J Channel along the bottom of each wall, following the guidelines provided in the Trim Applications section.
2. Proceed to install perimeter trims around door and window openings.
3. Cut the first panel to size for the initial row, ensuring proper alignment using a level and leaving a 1/8" gap between the panel's tongue side and adjoining trim. Fasten securely with recommended screws spaced at maximum 24" apart.
4. Leave a 1/4" clearance at each panel end to accommodate expansion and contraction, avoiding over-tightening screws.
5. If wall length exceeds panel lengths, use an H Channel (2 Piece) to join panels in the middle, referring to the Joining Panels section for guidance.
6. Continue installing wall panels row by row, interlocking the tongue of each new panel with the groove of the previous one for a secure connection.
7. Regularly check panel alignment using a level to ensure straight, even rows. Adjust positioning if needed.
8. Trim the top panel as necessary, ensuring a 1/8" gap between the panel edge and the ceiling.
9. Insert the top panel into the groove of the previous one.
10. Once panels reach the ceiling, install J Channel or Inside Corner Cove trim in each corner, ensuring a tight fit against the panels and secure to the wall.
11. Proceed to install trim and panels on the opposite wall, following the same procedure as the first wall.
12. Install panels on remaining walls by inserting each panel end into vertical trim pieces, sliding down into the bottom trim piece first, and interlocking the tongue and groove for subsequent panels.

Ceiling Installation

1. Start by placing J Channel around the ceiling perimeter, ensuring a tight fit against the wall panels and securing it to the ceiling.
2. Install TekKor® Wall & Ceiling System panels perpendicular to the ceiling joists. Use a stud finder if joists are not visible.
3. Cut the first panel to size for the initial row, positioning it parallel to the outer wall before fastening. Maintain a 1/8" gap between the panel's tongue side and adjoining trim, and secure with recommended screws spaced at maximum 24" apart.
4. Allow a 1/4" clearance at both panel ends for expansion and contraction, avoiding over-tightening screws.
5. If the ceiling length exceeds panel lengths, join panels in the middle using an H Channel (2 Piece), referring to the Joining Panels section for guidance.
6. Continue installing ceiling panels row by row, interlocking the tongue of each new panel with the groove of the previous one for a secure connection.
7. Regularly check panel alignment by measuring distances from the wall at both ends of the panel, ensuring even installation.
8. Trim the final ceiling panel as necessary, ensuring a 1/8" gap between the panel edge and adjoining trim.
9. Insert the last ceiling panel into the groove of the previous one and into the adjoining trims on each side for a secure fit.

Trim Applications

Installation Tips

- Tin snips are the safest and easiest tool to use when cutting trims; for a cleaner cut, avoid closing the blades at the end of a stroke (Figure B, Inside Cove Corner Trim)
- Trims should be screwed to the substrate at least once every 24" and at least 4" from the end of the panel
- If an area requires more than 10' of continuous trim, the trims should be butted tightly together with silicone sealant placed between the two pieces
- To create a water-tight corner at door and window openings, insert a small bead of silicone caulking on channel opening of trim pieces before installing panels

FIGURE B



Weather Accommodations

Tekkor panels should be acclimatized to a temperature between 10°C and 20°C (50°F and 68°F) for at least 24 hours prior to installation. If installation must occur below this temperature range, adhere to the following guidelines to prevent permanent damage or deformation due to temperature fluctuations or cold conditions:

Acclimatization

Ensure the products are acclimatized to the installation environment's temperature for at least 24 hours.

Seam Spacing

For temperatures below 4°C (40°F), place a nickel (1.95mm/0.077") between the seams of all panels before securing them to allow for extra spacing. For temperatures between 4°C (40°F) and 10°C (50°F), use a dime (1.35mm/0.053") for spacing.

Panel Ends

Increase the spacing at panel ends from the standard ¼" to 3/8". For joining panel ends, use the H Channel Snap-In trim kits, which include a wide face trim suitable for covering the additional gap. These guidelines are specific to accommodating temperature changes. If the installation occurs outside the recommended range and the temperature is constant, such as in a walk-in refrigerator at a steady 6°C, additional spacing is not required.

Handling Impact

Be aware that Tekkor panels may become more brittle below 15°C (59°F), increasing the risk of damage from direct impacts.

Cutting

For clean cuts, follow the instructions in the installation guide. Below 5°C (41°F), cut the panels more slowly to prevent chips or cracks. Conduct a test cut first to gauge panel performance.

Trims

Trim pieces should be cut slowly when temperatures fall below 5°C to prevent cracking. Use tin snips where possible to minimize the risk of damaged edges.

Radiant Heat

Ensure all radiant heat sources are shielded with a minimum clearance of 24 inches from Tekkor panels. Check with the heater manufacturer for additional shielding and clearance guidelines.

Sunlight

Be cautious of prolonged sunlight exposure in cold climates as it can cause exposed panels to expand differently from those in the shade. Following these guidelines will help ensure the stability of the installed system.

Disclaimers

The manufacturer is not responsible for problems related to expansion due to temperature fluctuations. If wide temperature fluctuations exist in the area of the installation, allow for expansion and contraction gaps in moldings and perimeter. Before installation, TekKor® Wall & Ceiling Systems and trims should be acclimatized to minimize expansion and contraction issues. Our drive to continually develop better-looking, better-performing, and more sustainable products can result in minor changes to the color and texture of our products when compared to previously manufactured products. Therefore, install products of the same package and/or pallet when completing your project to ensure the best possible results to minimize any minor variations.

Wall Installation

Start by installing Base Trim or J Channel along the bottom of the wall, ensuring consistency with trimming guidelines provided in the document's Trim Applications section, and maintain the same corner-trimming approach for both top and bottom trim pieces.

Install the remaining J Channel at the top of the walls.

J Channel



Base Trim

Base Trim

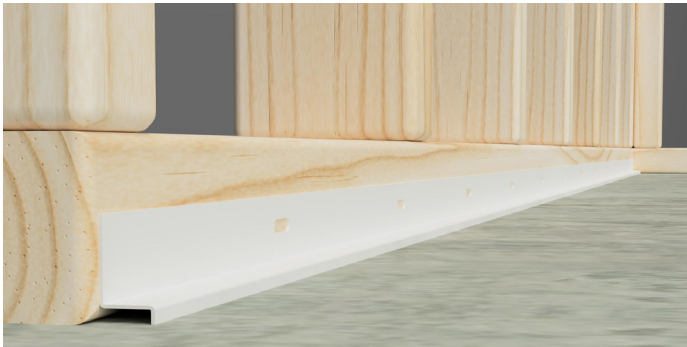

J Channel



3/8" Gap

Use J Channel or Inside Cove Trim for corners, beginning with the corner where the J Channel was cut 3/8" short, and offset the vertical trim piece by 3/8" to accommodate the final wall panel insertion.



J Channel



Base Trim

Wall Install Continued

Cut the first panel to size, starting from the corner where the J Channel was cut $\frac{3}{8}$ " short, ensuring alignment with the outer wall before fastening. Maintain a $\frac{1}{8}$ " gap between the panel's tongue side and adjoining trim, and secure with recommended screws spaced at least 24" apart.



Allow a $\frac{1}{4}$ " clearance at both ends of panels for expansion and contraction, avoiding over-tightening screws.

Install subsequent wall panels, interlocking the tongue of each new panel with the groove of the previous one, ensuring a secure connection before fastening.



Slide corner panel back where you created the $\frac{3}{8}$ " gap. Ensure you cut top flange off at this time for a snug fit.

